

NEW	REVISIONS			
7-16-90	10-11-91	3-2-98	10-11-04	7-31-07

ST. LOUIS COUNTY PROJ.

SHEET NUMBER	TOTAL SHEETS

GENERAL NOTES

- 1) Do not scale drawing, follow dimensions.
- 2) All wood to be treated in accordance with American Wood Preservers Association C2 or C9, or Missouri State Department of Agriculture Certification 2CSR 7070.015. Timbers which are not marked or labeled by one or the other of these agencies cannot be approved.
- 3) All railroad tie retaining walls shall be constructed with new timbers.
- 4) Railroad Tie Retaining Walls are not for use within the right-of-way or to retain roadway fill or below headwall elevation of detention basin.

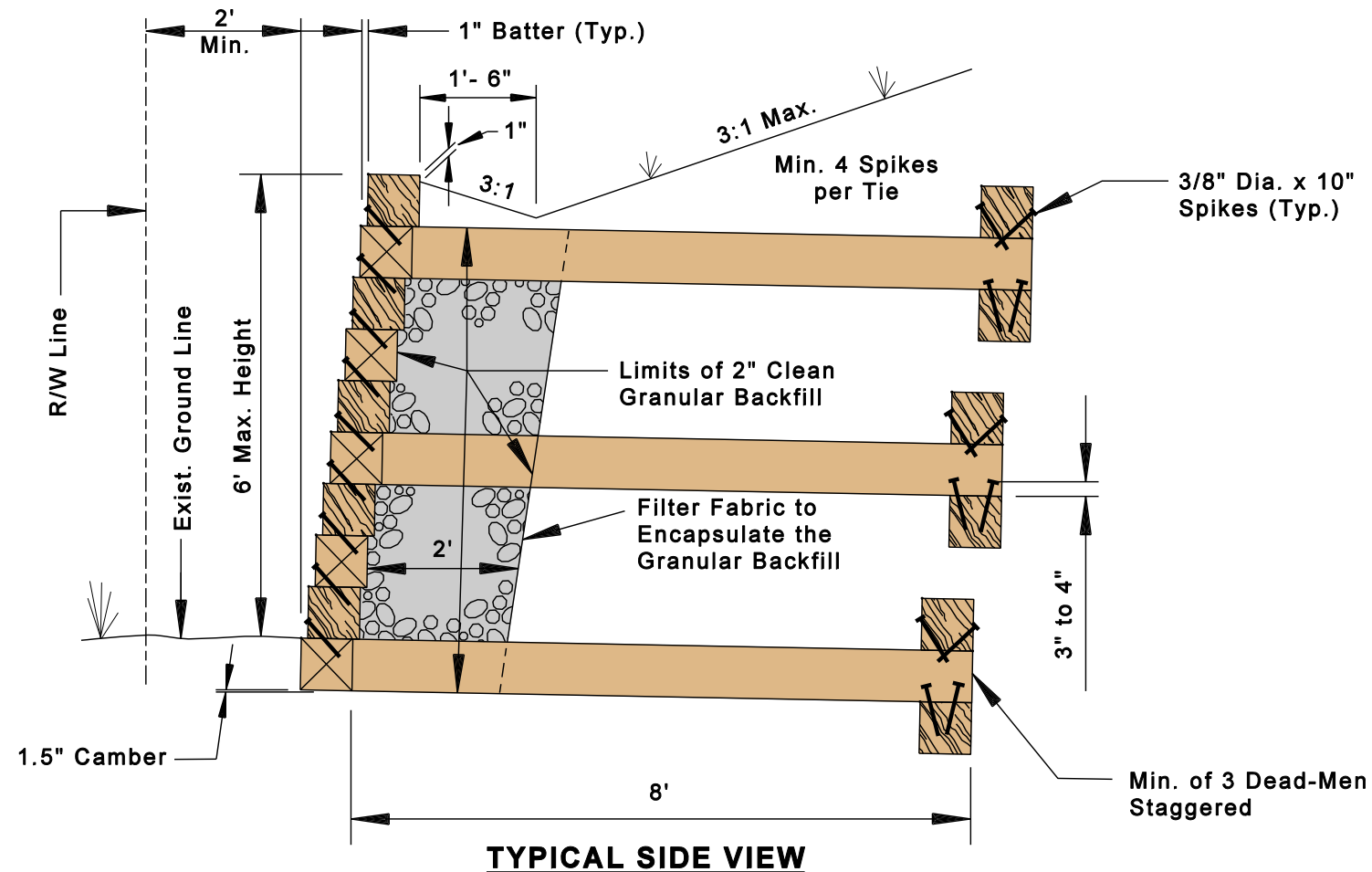

TYPICAL SIDE VIEW

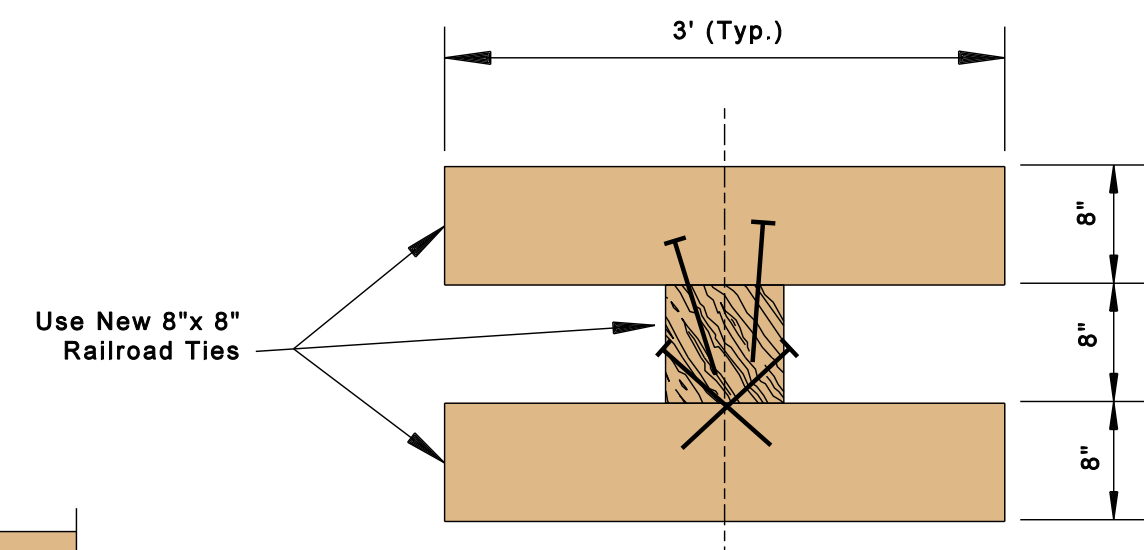

END VIEW DEAD-MEN ANCHOR TIES

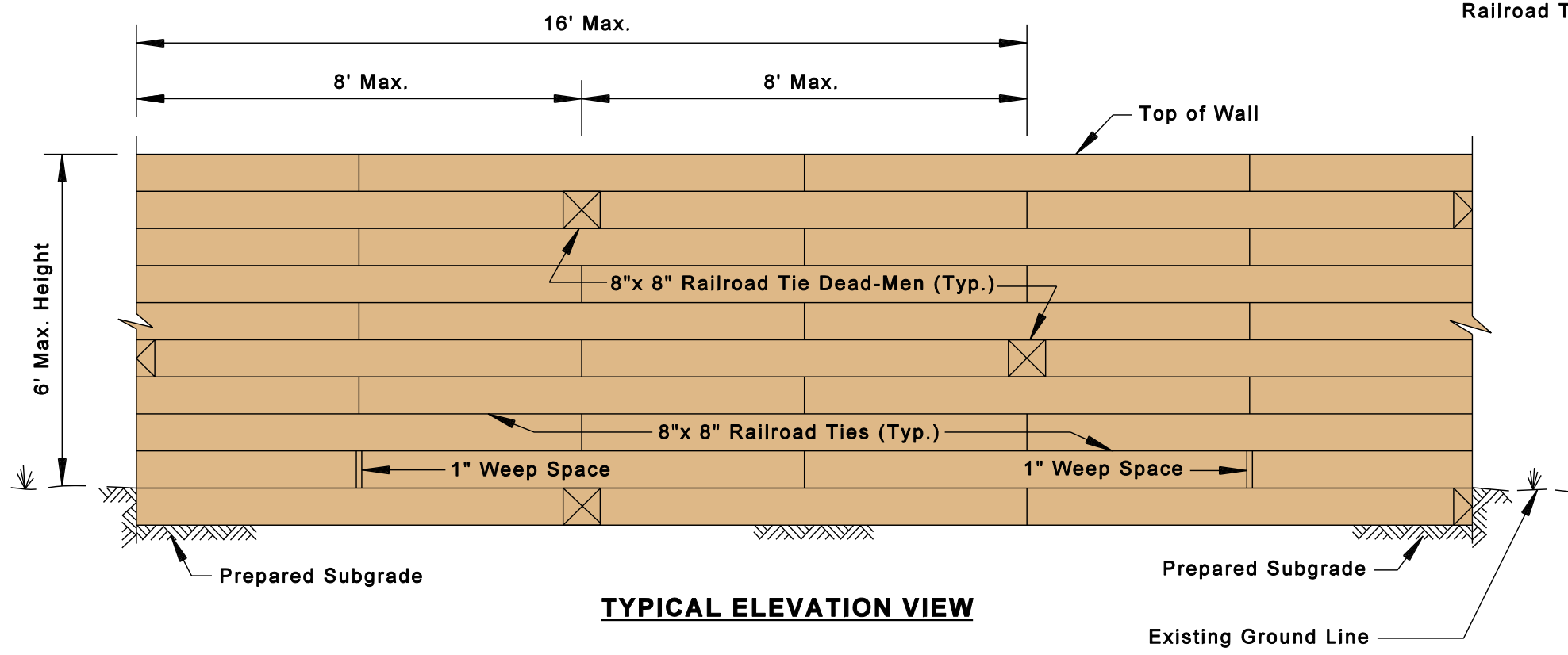

TYPICAL ELEVATION VIEW

SAINT LOUIS COUNTY
DEPARTMENT OF HIGHWAYS AND TRAFFIC
CLAYTON, MISSOURI

RAILROAD TIE RETAINING WALL

REVISION DATE: July 31, 2007

DRAWING
C723.00